

### CUT WHEREVER YOU WANT !

The linear light without cutting unit.

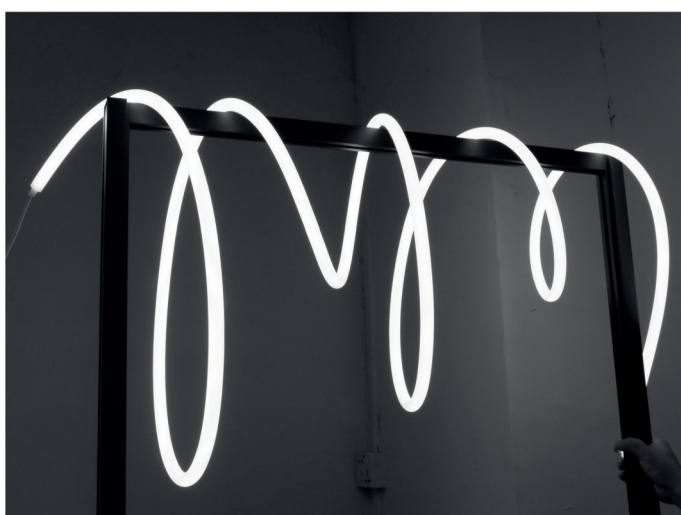
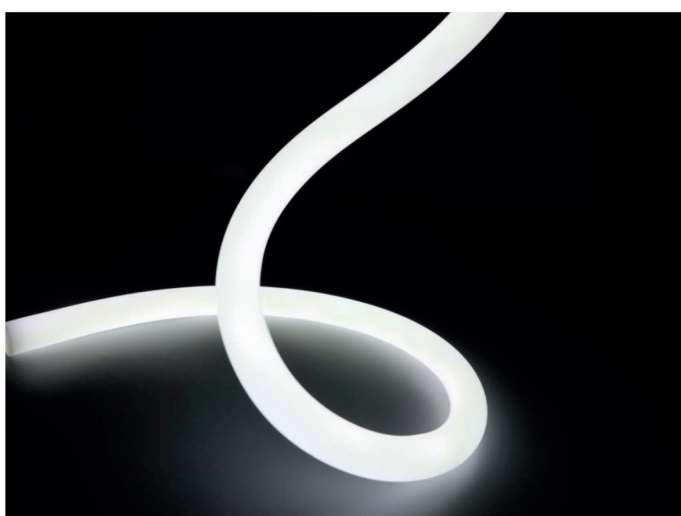
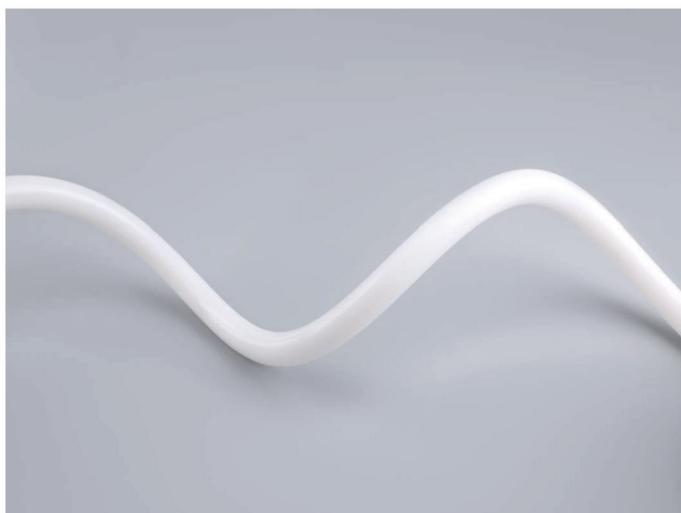

#### FEATURES

REV00

- Circular tube design with light emitting 360° performance, available to build many patterns and arts for decoration.
- Uniform, dot-free, smooth and comfortable luminary up to 5M[16.4ft.] run length.
- White color with diameter in 13mm[0.51in.].
- On field cuttable and assembly, free cutting to be any desired length, with end cap sealed by gluing process or die-casting process.
- IP67 for indoor and outdoor usage.
- Dimmable available with PWM signal.
- Compared with traditional fragile glass and harden/ yellowing easily PVC sheathing material, silicon extrusion technology is an advanced process, with high-efficiency production capacity and environmentally-friendly characteristics. Additionally, with high grade appearance, soft bend flexibility, strong impact resistant and high weather resistance.
- 50,000h long lifespan, 5 years warranty.

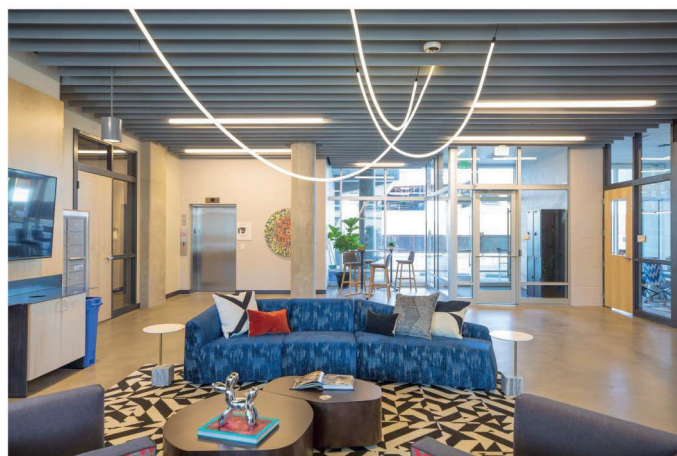

\*UL in progress

### Dimension (End cap sealed by die-casting process)

L: Total length  
Lb: Illumination surface length  
N: Number such as 1,2,3 .....N

La: Length of LED strip light  
L1: Increment



### Dimension (End cap sealed by gluing process)

L: Total length  
Lb: Illumination surface length  
N: Number such as 1,2,3 .....N

La: Length of LED strip light  
L1: Increment

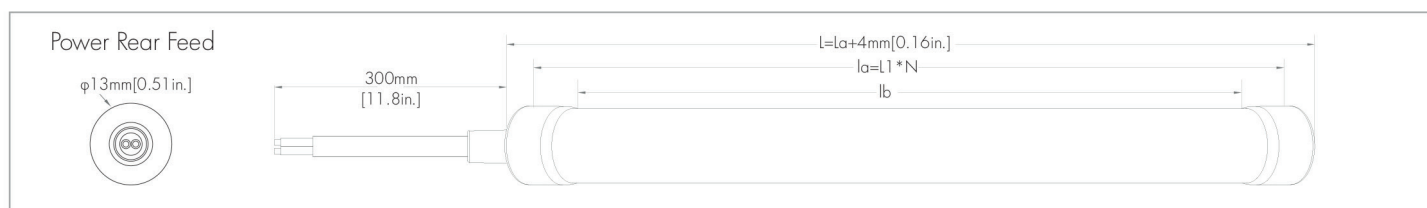

### Cutting

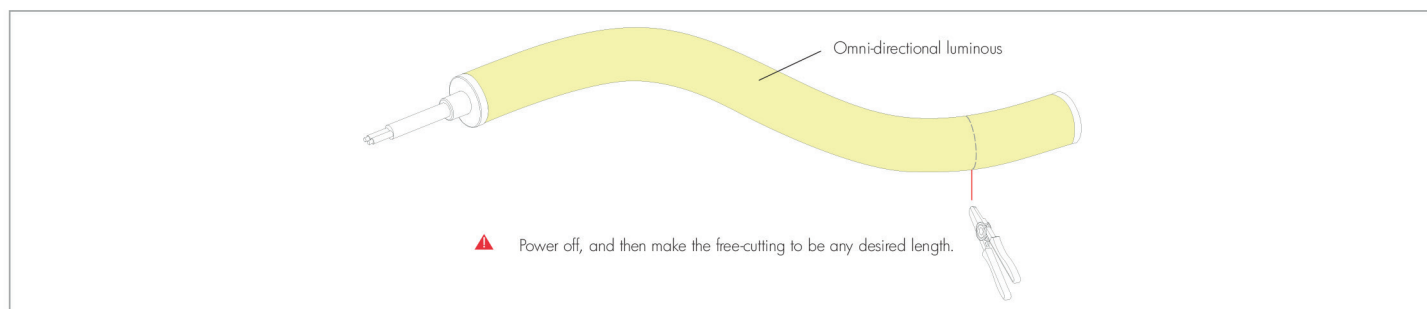

### Assembly

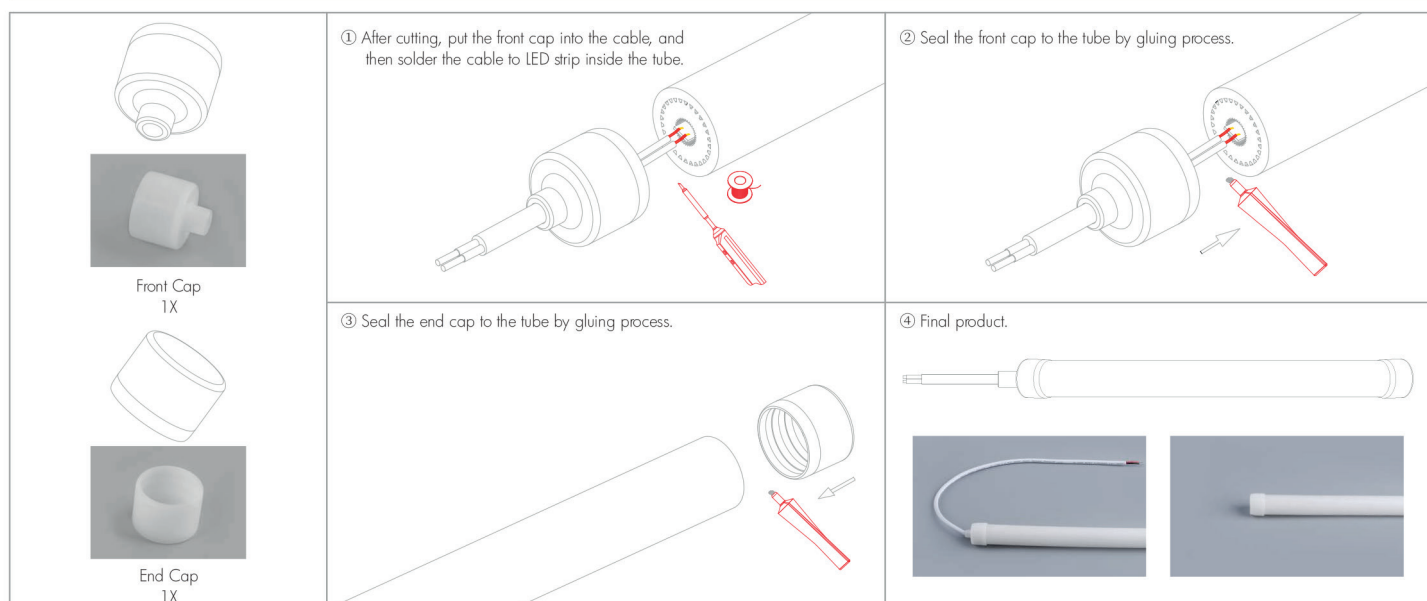

## General Parameters

Style	Dimension	Max. Run Length (La) & Max. Shipping Length	Increment (L1)	LED Type	LED QTY	IP&IK Rating	Operating Ambient	Lifespan	Warranty
Multi-bending	φ13mm [φ0.51in.]	5M [16.4ft.] & 10M [32.8ft.]	<b>ZERO MODULES TECHNOLOGY</b> <i>cut it wherever you want</i>	SMD 2216	480LED/M [146LED/ft.]	IP67 [wet] & IK06	Ta(working): -20~45°C [-4~113°F] & Tstg (storage): -20~60°C [-4~140°F]	50,000h (L70@Tc ≤65°C [149°F] Tc is temp. of LED pin.)	5 years

## Photoelectric Parameters

Style	Power ±10%	Operating Voltage	Finished Product CCT/ Wavelength	CRI80, 4000K	CRI90, 4000K		Beam Angle
				Luminous Flux±10%	Luminous Flux±10%	Light Efficiency	
Multi-bending	10W/M [3.05W/ft.]	24VDC	2700K±120K 3000K±150K 3500K±300K 4000K±300K 5000K±400K 6000K±500K	/	700lm/M [213lm/ft.]	70lm/W	360°

## Note:

- (1) luminous flux for CCT 2700K is 10% lower, for CCT 3000K/3500K is 5% lower, for CCT 5000K/6000K is the same, compared with 4000K.
- (2) The Max. Length (La) is defined as power fed on one side.
- (3) The power of the strip need to be reduced to 7W/M[2.13W/ft.]@White&24V and 8W/M[2.44W/ft.]@White&48V for operating ambient temperature in -20~55°C[-4~131°F].
- (4) The standard packing length is fixed by default per reel without installation accessories, customized packing need to be evaluated.
- (5) Installation accessories pack should be ordered separately according to specific case.

## Light Distribution Diagram

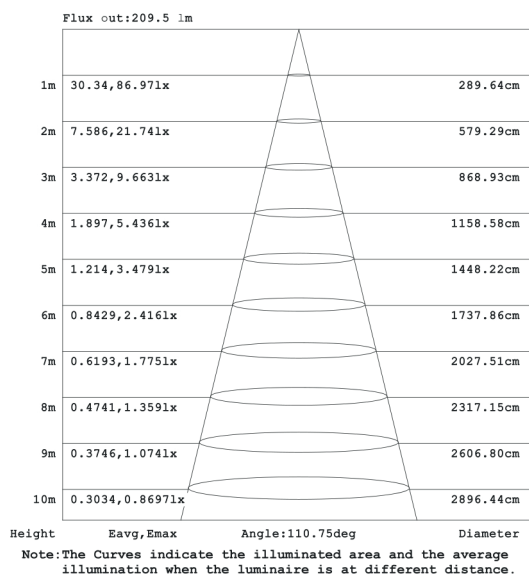
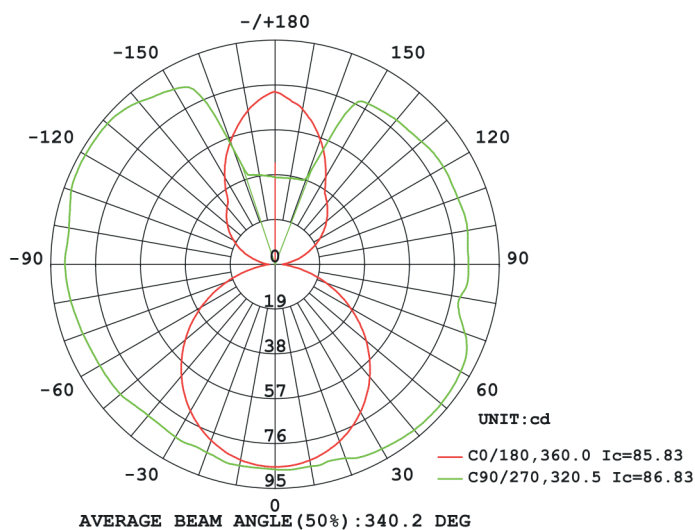

4000K, CRI90

## Installation

(1) Fixed by transparent bracket.

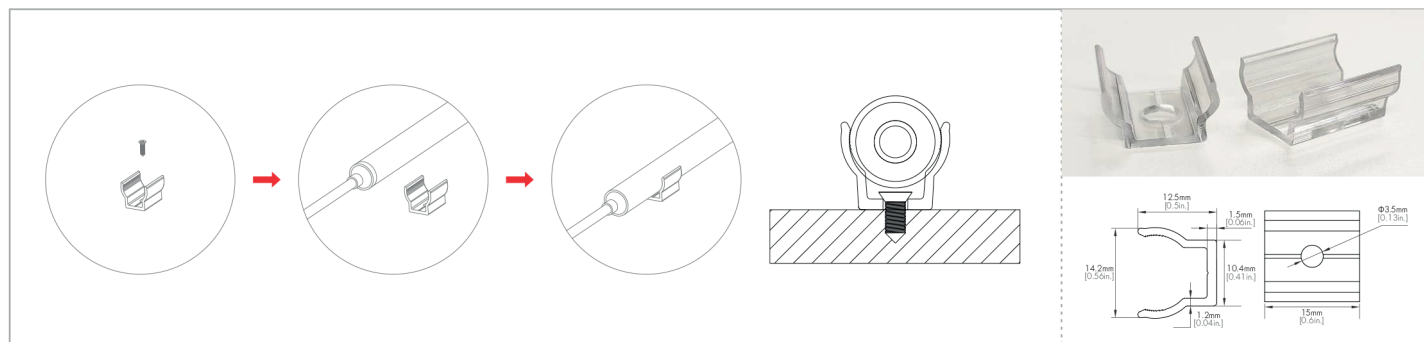

(2) Fixed by transparent PC channel.

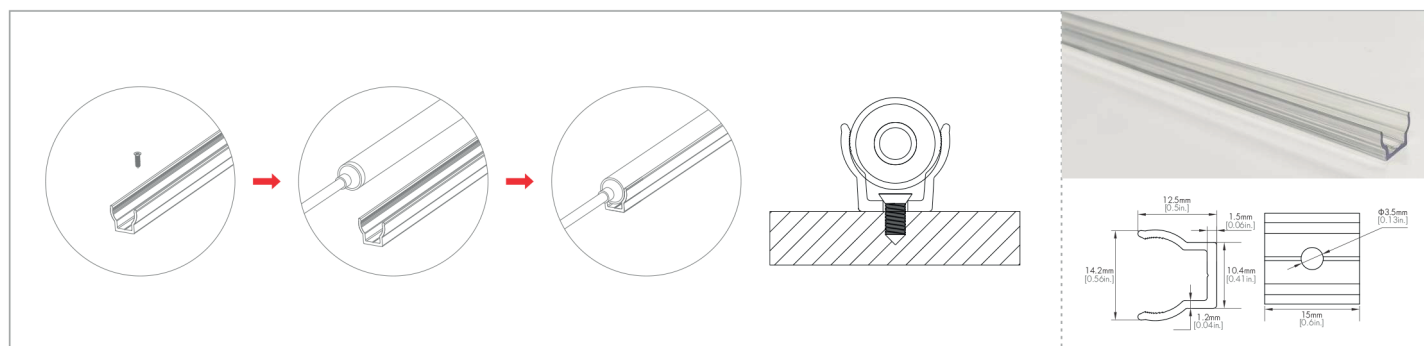

## Connection

Non-Dimming Status for Single Color

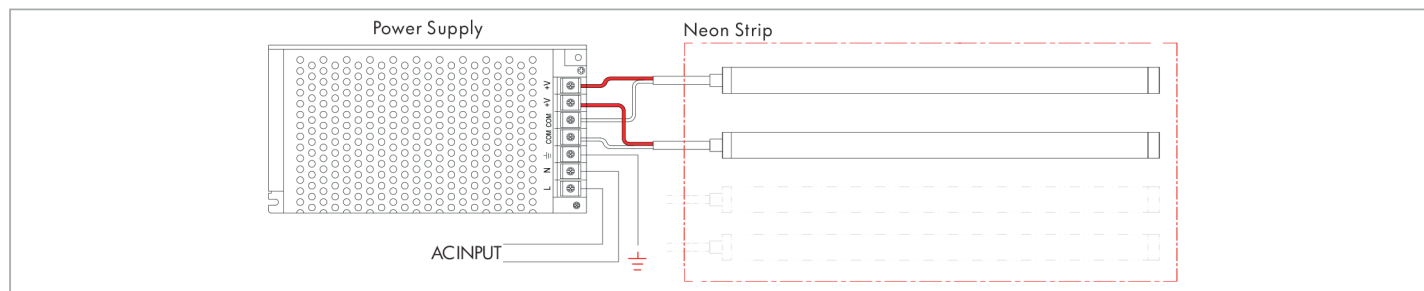

Dimming Status for Single Color

### Notice

---

1. Adopt suitable power supply with power is 20% higher than the max. power of product, to ensure long time performance of power supply.
2. Do not install it when power is on. Before powering on, make sure the wiring is correct.
3. Avoid privately changing or damaging the circuit or other component on the product.
4. Avoid scrape, twist and irregular bend during installation, which might cause non repairable status for the product.
5. Minimum bending diameter definition is 100mm[3.94in.], too small bending diameter will break the product.
6. Minimum twist angle is 360° per 1000mm[39.4in.] length.
7. product linked in over long length will lead to problem of overload or uneven brightness.
8. To protect your eyes, do not stare at the product for a long time while it's illuminated.
9. Only professional personnel can install, dismantle and repair the product.
10. Bend and twist diagram is shown as below.

