



## STORM MEDIUM OUTPUT

datasheet



Project: Private Residence | Lighting design: ONE A

The STORM SYSTEM® collection is carefully designed to flush the surface of any ceiling or wall, and all products will appear with an absolute minimum of tolerance and visibility.

Storm Medium Output is designed to integrate the canopy into the ceiling. A beautiful way to install and fasten your pendants. The wire disappears elegantly into the ceiling.

## GENERAL DATA

### Collection

STORM SYSTEM®

### Product

Storm Medium Output

### Article no.

1A01.0500.xx

## SPECIFICATIONS

### Weight

350 g / 1000 g

12.3 oz / 2.2 lbs

### Material

Aluminium / Brass

### Load

Please refer to the chosen installation ring's datasheet

### Labelling



## ADDITIONAL REQUIREMENTS: (not included)

### Installation Rings – choose one of the installation rings below

- Storm Medium Plaster Ring – 1A01.0001.01
- Storm Medium Acoustic Adaptor – 1A01.0091.00
- Storm Medium Back-Mounted Ring – 1A01.0048.xx
- Storm Medium Back 007 Ring – 1A01.0047.04
- Storm Medium Concrete Cabinet A|B|C – 1A01.008X.xx
- Storm Medium Concrete Halo-X BMR – 1A01.0055.xx (n/a North America)
- Storm Medium Extension S150 – 1A01.0017.xx
- Storm Medium Extension S350 – 1A01.0035.xx

## XX-COLOUR CODES



01 – white



92 – black pearl

## NOTE

By installation of pendants it is important to be aware of pendants load/weight. For max. load please refer to the installation ring's datasheet.

If your pendant exceeds the specified load – an additional anchor must be completed!

Pendant cord must be a min. of Ø3 mm / 0.12" and a max. of Ø8 mm / 0.31" .

Storm Medium Output can be installed in sloped ceilings with an angle of up to 45°



## INSTALLATION DEPTH

The installation depth may vary if Storm Medium Cabinet is chosen, please review datasheet for installation depth

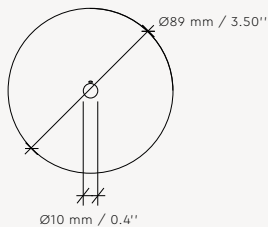
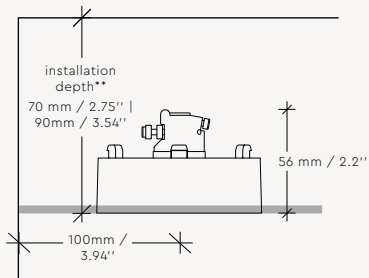

(\*) Brass is a natural product and colour will change over time

(\*\*) In combination with Storm Back-Mounted Ring (and entrance for junction box) – Installation depth can be reduced to 70mm / 2.75" if heat shrink crimping cable connection is used.



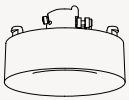

#### components

- Storm Medium Output

#### IMPORTANT INFORMATION

Installation and mounting must be performed by a certified electrician only, and instructions must be followed. Always make sure the main power is off during installation. Pay attention to the fixture remarks, and always make sure to use the correct voltage.

#### CLEANING AND MAINTENANCE:

Use a soft moist cloth for cleaning. No further maintenance is required.

#### WARRANTY:

If the product is defect, please contact your supplier immediately. Please note that warranty will not apply in case of wrongful use or if unskilled personnel attempts to repair.



The crossed-out wheeled bin symbol indicates that the item should be disposed of separately from household waste. The item should be handed in for recycling in accordance with local environmental regulations for waste disposal

For more information, please contact [info@onea.dk](mailto:info@onea.dk)

## ASSEMBLY INSTRUCTION

### STEP 1

Adjust the length of the cord, leaving the fixture at the desired height. Fasten the cord properly, and test that the load of the chosen fixture is held in place.

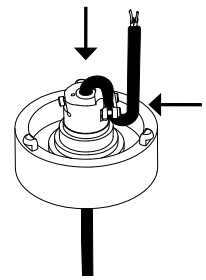

### NOTE

Please note, if pendant weight exceeds the max. load specified in the chosen installation ring's datasheet, the steel wire must be anchored in additional ceiling support.

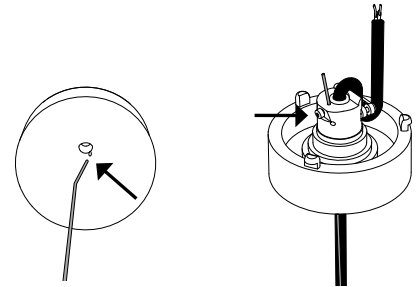

### STEP 2

**Make sure the power is OFF!**

Connect the cables

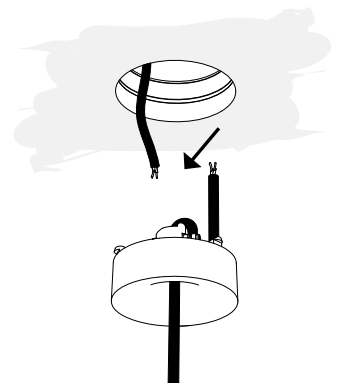

### STEP 3

Then mount the fixture into the installation ring. Do this by slightly rotating the fixture until it locks.

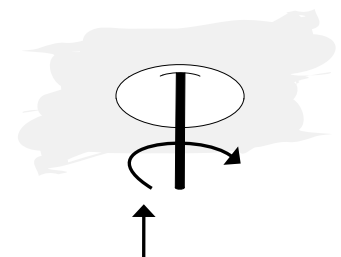

### STEP 4

Please ensure that the fixture aligns with the ceiling.

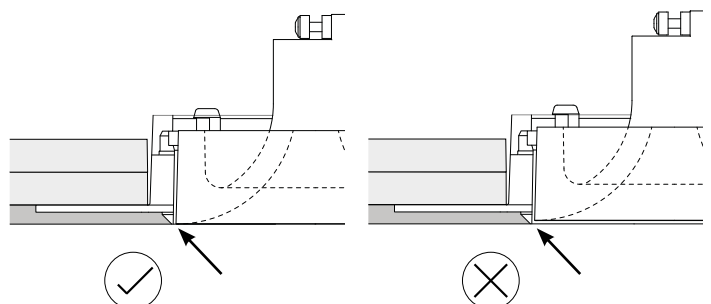

## DISASSEMBLY INSTRUCTION

---

### STEP 1

Take hold of the pendant cable and twist it until it stops. Gently push the Output (and pendant cable) upwards, then turn gently until it reaches the position where it can come out.

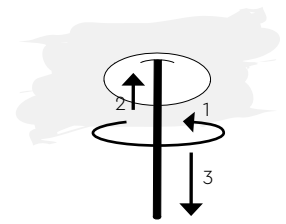

### STEP 2

**Make sure the power is OFF!**

Disconnect the cables

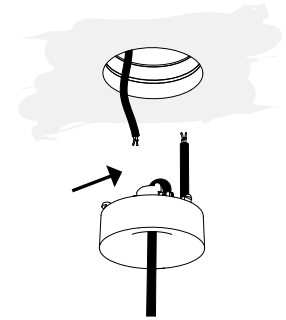

---

### IMPORTANT INFORMATION

Installation and mounting must be performed by a certified electrician only, and instructions must be followed. Always make sure the main power is off during installation. Pay attention to the fixture remarks, and always make sure to use the correct voltage.

### CLEANING AND MAINTENANCE:

Use a soft moist cloth for cleaning. No further maintenance is required.

### WARRANTY:

If the product is defect, please contact your supplier immediately. Please note that warranty will not apply in case of wrongful use or if unskilled personnel attempts to repair.



The crossed-out wheeled bin symbol indicates that the item should be disposed of separately from household waste. The item should be handed in for recycling in accordance with local environmental regulations for waste disposal

For more information, please contact [info@onea.dk](mailto:info@onea.dk)