



## STORM SMALL MOTION

datasheet



Project: ONE A Showroom | Lighting design: ONE A

The STORM SYSTEM® collection is carefully designed to flush the surface of any ceiling or wall, and all products will appear with an absolute minimum of tolerance and visibility.

Storm Small Motion is a fixture which in combination with a Motion Kit will provide a motion detector. Available sensors; 230V Master, 230V Slave, KNX, DALI

## GENERAL DATA

### Collection

STORM SYSTEM®

### Product

Storm Small Motion

### Article no.

1A00.0200.xx

## SPECIFICATIONS

### Weight

146 g / 5.15 oz

### Material

Aluminium and  
Polycarbonate

### IP protection grade

IP20 / IP54

### Labelling

CE

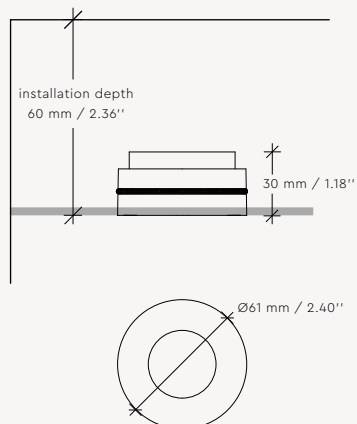

## XX – COLOUR CODES



01 – White



92 – Black Pearl

## NOTE

Storm Small Motion is a motion sensor that consists of two components:

1. A fixture ring from the STORM SYSTEM® collection – 1A00.0200.xx
2. A Motion kit sensor with optional accessories – 1AK.0200.xxxx

select a motion kit and optionally an accessory from the list below

## ADDITIONAL REQUIREMENTS (not included)

**Installation rings** – choose one of the installation rings below

- Storm Small Plaster Ring – 1A00.0002.01
- Storm Small Back-Mounted Ring – 1A00.0049.xx
- Storm Small Back 007 Ring – 1A00.0047.04
- Storm Small Extension S120 – 1A00.0017.xx
- Storm Small Extension S300 – 1A00.0035.xx

**Motion Detectors** – choose one of the motion kits listed below

### KNX (IP54)

Motion Kit KNX FLAT DX ➤  
– 1AK.0200.93523

Motion Kit KNX FLAT ST ➤  
– 1AK.0200.93522

### Accessories

Remote for KNX ➤  
– 1AK.0200.92123

IR-PD-KNX-Mini ➤  
– 1AK.0200.93398

BLE-IR adaptor smartphones ➤  
– 1AK.0200.93067

### Description

These sensors are used when connecting a KNX installation. There are 2 software versions of B.E.G's latest PD11-KNX version

ST – Standard: Used in areas where dimming of lighting is needed  
1 pcs. light channel and 3 pcs. HVAC outputs,  
1 pcs. slave output

DX – Deluxe Used where dimming of lighting, control of HVAC signals, slave outputs are needed and where temperature and microphones are needed. Presence simulation and dynamic run-time. Local parameters can be programmed via a remote control.

**Note:** it is important that the correct database for the KNX sensor in question is downloaded from the B.E.G website

### ON-OFF (IP20)

Motion Kit 230V Master ➤  
– 1AK.0200.92583

Motion Kit 230V Slave ➤  
– 1AK.0200.92593

### Accessories

Remote control master ➤  
– 1AK.0200.92159

Remote control ➤  
– 1AK.0200.92520

BLE-IR adaptor smartphones ➤  
– 1AK.0200.93067

### Description

Sensor for a traditional on/off stand-alone light control

This type is used for a traditional lighting installation, where the sensor switches light sources, LED spot, etc. on and off.

A remote control is required to program this product if you do not want to make use of the factory settings of 500 Lux and a running time of 10 min.

Installation instructions: In case of master – slave combination, the master sensor must always be installed in the area with minimum daylight

**16-48V (IP20)****Description**

Motion Kit 16-48V White ➤  
- 1AK.0200.92594

Sensor for primary use in connection with IHC system  
This sensor is used when there is operating voltage of 16-48 V.

**Accessories**

Remote control ➤  
- 1AK.0200.92185

The sensor's potential-free contact kits can only be used to control signals from e.g. IHC system or CTS system, etc. contact kits CANNOT be used to pull a physical load.

The sensor has outer belts 2 0-10V outputs giving a LUX value and temperature (in volts) respectively  
These sensors are mounted in a parallel line using several sensors to extend the detection range

**DALI BROADCAST (IP20)****Description**

Motion Kit Daco-Dali ➤  
- 1AK.0200.93459

DALI BROADCAST is an independent DALI solution that can be used in office/business/buildings where you want intelligent light control and dimming of light via DALI.

Motion Kit 230V Slave ➤  
- 1AK.0200.92593

This type is used with a completely traditional light installation, where the sensor switches on, daylight regulates and switches off all DALI drivers connected to the DALI-bus (up to 50 drivers), the sensor can control driver types DT0, DT5, DT6 and DT7.

**NOTE!**

Please be aware of installation depth of motion kit components and installation passage in Storm Small Motion

A remote control must be used to program this product if you do not wish to use the factory setting of 500 Lux and a run-on time of 10 min.

**Required Accessories**

BLE-IR adaptor smartphones ➤  
- 1AK.0200.93067

Installation instructions: In case of a master-slave combination, the master sensor must always be installed in the area with the least amount of daylight.

(1 pcs./delivery)

The sensor is DALI2 certified and has advanced functions such as minimum and maximum values, selection of start-up level, etc.

**DALI LINK (IP20)****Description**

Motion Kit DALI Link ➤  
- 1AK.0200.93840

DALI Link is a single-room DALI solution that can be used in houses / buildings where you want intelligent lighting control and dimming of lighting via DALI

Motion Kit DALI Link sensor ➤  
- 1AK.0200.93068

The system can control up to 25 DALI light sources per power supply. It is possible to connect 2 power supplies in parallel with each other enabling control of up to 50 DALI light sources. A DALI push button module must be used for programming. However, this can be removed after programming is completed if no override option is needed.

**NOTE!**

Please be aware of installation depth of motion kit components and installation passage in Storm Small Motion

**Accessories**

Motion Kit DALI Link ➤  
Power Supply  
- 1AK.0200.92846

The push button module has integrated Bluetooth, which allows the lighting to be controlled via a smartphone or tablet. It is also possible to program scenarios (up to 16) in connection with override. These scenarios can also be controlled via a smartphone.

Motion Kit DALI Link ➤  
Push Button Module  
- 1AK.0200.92732

DALI LINK can daylight regulate in up to 2 zones.

Motion Kit DALI Link ➤  
Power supply large  
- 1AK.0200.93189

All sensors and push button modules are supplied directly via the DALI bus connected to the power supply (which is located above the ceiling)

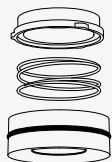

#### COMPONENTS

- Storm Small Smoke Relay
  - Retaining Disk
  - Spring



- Motion Kit (sold separately)

#### PLEASE NOTE:

If the spring on the fixture is damaged, do not proceed installation – contact your dealer

#### IMPORTANT INFORMATION

Installation and mounting must be performed by a certified electrician only, and instructions must be followed. Always make sure the main power is off during installation. Pay attention to the fixture remarks, and always make sure to use the correct voltage.

#### CLEANING AND MAINTENANCE:

Use a soft moist cloth for cleaning. No further maintenance is required.

#### WARRANTY:

If the product is defect, please contact your supplier immediately. Please note that warranty will not apply in case of wrongful use or if unskilled personnel attempts to repair.



The crossed-out wheeled bin symbol indicates that the item should be disposed of separately from household waste. The item should be handed in for recycling in accordance with local environmental regulations for waste disposal

For more information, please contact [info@onea.dk](mailto:info@onea.dk)

## ASSEMBLY INSTRUCTION

### STEP 1

Place the chosen Motion Kit in the fixture ring. Place the spring and retaining disk over the Motion Kit

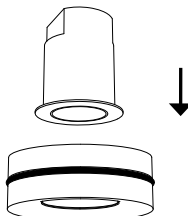
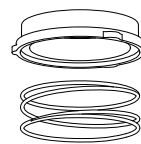

### STEP 2

Gently rotate the retaining disk until it snaps into place

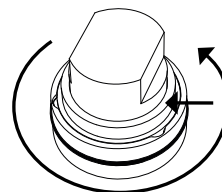

### STEP 3

Connect the supply cable.

Mount the fixture into the plaster ring/back-mounted ring.

Do this by slightly rotating the fixture into the plaster ring/back-mounted ring.

**NOTE:** When rotating the fixture choose the direction with the least resistance.

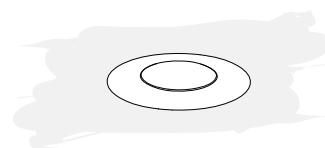
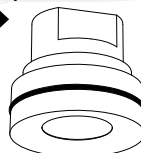
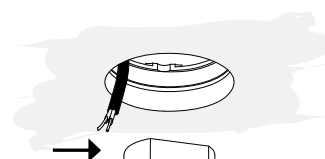

## DISASSEMBLY INSTRUCTION

### STEP 1

Lightly push in the center, thereby creating space to take hold of the fixture.

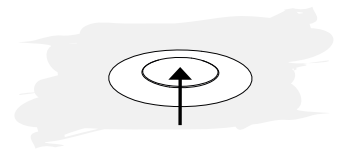

### STEP 2

Take hold of the fixture.

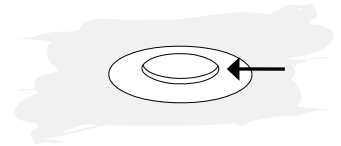

### STEP 3

Pull down gently, whilst slightly rotating. Disconnect the cables.

**NOTE:** When rotating the fixture choose the direction with the least resistance.

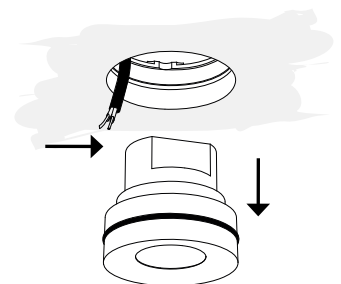

## TO REMOVE OR CHANGE MOTION KIT

### STEP 1

Gently rotate the retaining disk until you smoothly can remove the retaining disk out from under the ridge of the fixture.

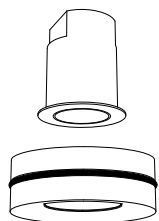
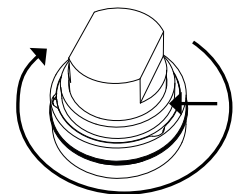

### IMPORTANT INFORMATION

Installation and mounting must be performed by a certified electrician only, and instructions must be followed. Always make sure the main power is off during installation. Pay attention to the fixture remarks, and always make sure to use the correct voltage.

### CLEANING AND MAINTENANCE:

Use a soft moist cloth for cleaning. No further maintenance is required.

### WARRANTY:

If the product is defect, please contact your supplier immediately. Please note that warranty will not apply in case of wrongful use or if unskilled personnel attempts to repair.



The crossed-out wheeled bin symbol indicates that the item should be disposed of separately from household waste. The item should be handed in for recycling in accordance with local environmental regulations for waste disposal

For more information, please contact [info@onea.dk](mailto:info@onea.dk)